

Warning:

- Be sure to check all packing material carefully for small parts, which may have come loose inside the carton during shipment.
- To prevent possible scratches and damage, this furniture **MUST BE ASSEMBLED BY TWO PEOPLE** on a soft surface such as a blanket or carpet.

Hardware and Parts packed with the Headboard

King Uph Spindle Headboard (Top Assembly) - 91484

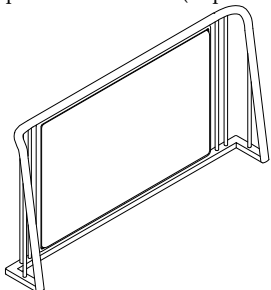

(H-A)

1 pc.

Headboard (Bottom Assembly) - 91484

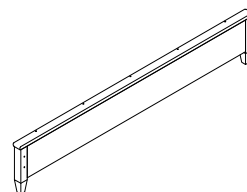

(H-B)

1 pc.

Allen Head Bolt
Ø5/16" - 18 x 1-7/8"

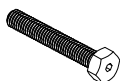

(H-C)

8 pcs.

Spring Washer
Ø5/16"



(H-D)

8 pcs.

Flat Washer
Ø5/16" x Ø19mm



(H-E)

8 pcs.

Open Wrench
12 mm

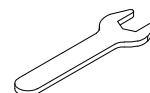

(H-F)

1 pc.

Hardware and Parts packed with the Footboard

King Spindle Footboard
91485

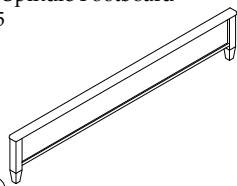

(F-A)

1 pc.

Wood Slats (78-3/8" long)

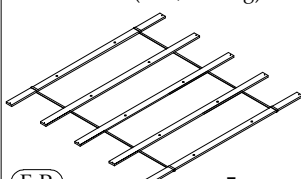

(F-B)

5 pcs.

Support leg
(9-7/8" x 1-1/2" x 1-1/2")



(F-C)

10 pcs.

Wood Screw
Ø4 x 30 (mm)

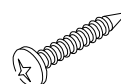

(F-D)

10 pcs.

Screw Driver
(not included)



Hardware and Parts packed with the Bed Rails

King-Queen Side Rails (Left)
91476

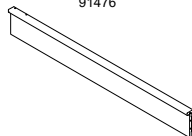

(R-A)

1 pc.

King-Queen Side Rails (Right)
91476

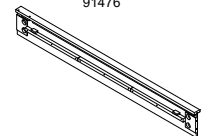

(R-B)

1 pc.

Curved Washer
Ø5/16"



(R-C)

8 pcs.

Spring Washer
Ø5/16"



(R-D)

8 pcs.

Hex Nut
Ø5/16" x 17mm



(R-E)

8 pcs.

All-Thread Bolt
Ø5/16" - 18 x 3-1/8"



(R-F)

8 pcs.

Open Wrench
12 mm



(R-G)

1 pc.

King Uph Spindle Bed

91484 -- King Uph Spindle Headboard

91485 -- King Spindle Footboard

91476 -- King-Queen Side Rails (Right/Left)

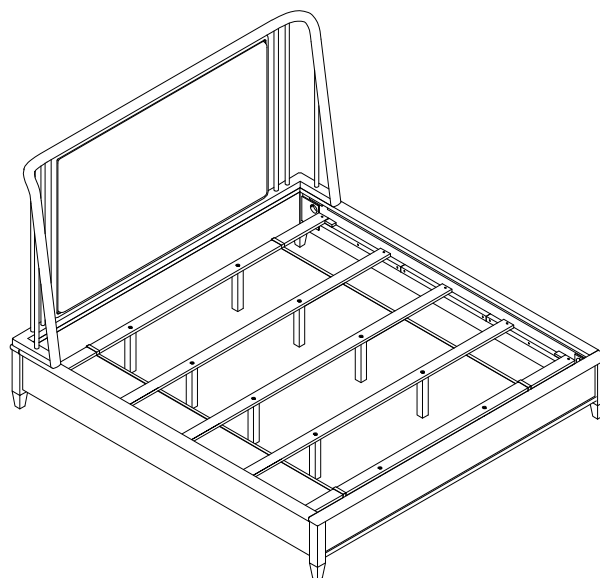

King Uph Spindle Bed

91484 -- King Uph Headboard (Bottom Assembly)

91485 -- King Spindle Footboard

Step 1

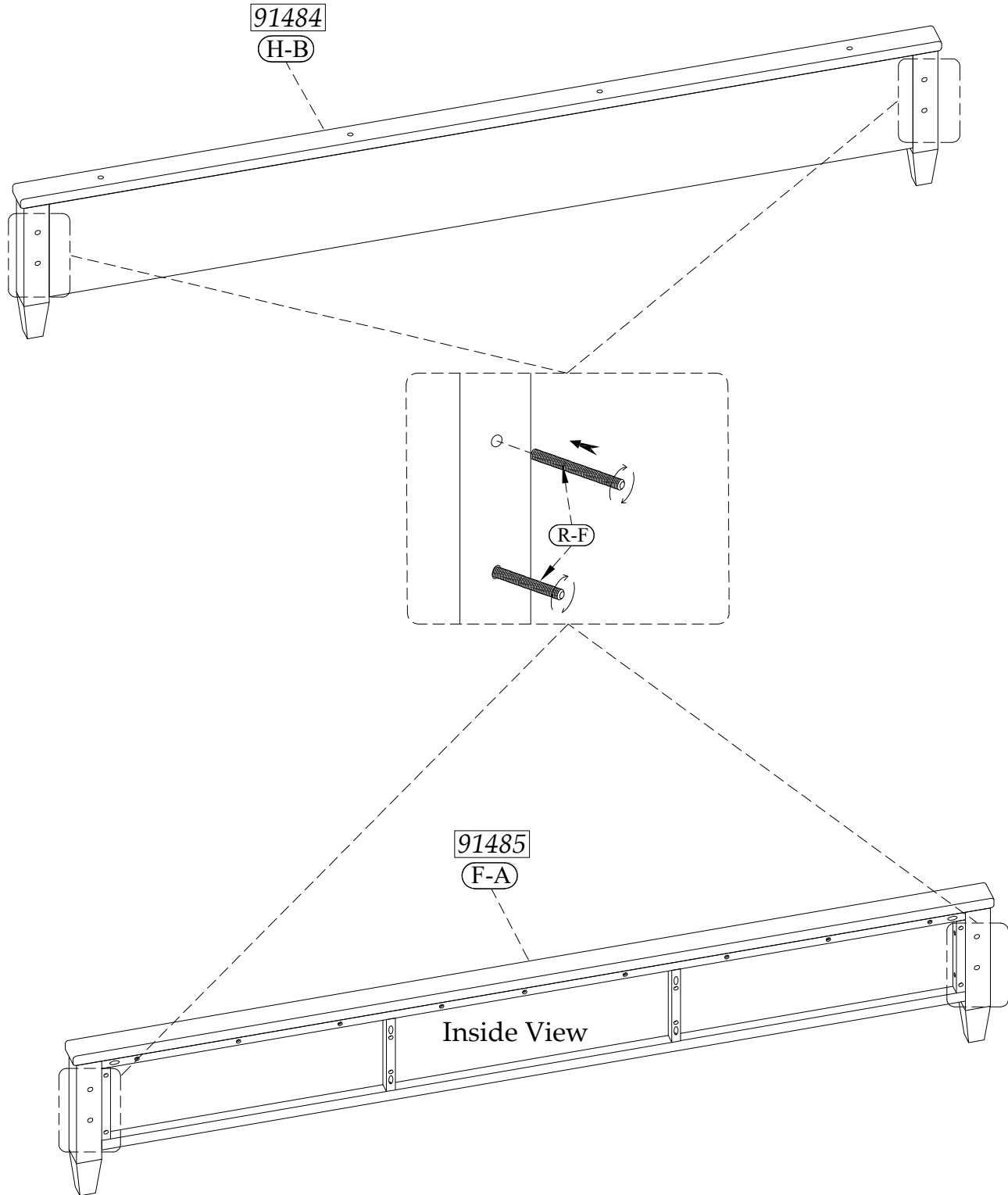

King Uph Spindle Bed

91484 -- King Uph Headboard (Bottom Assembly)

91485 -- King Spindle Footboard

91476 -- King-Queen Side Rails (Right/Left)

Step 2

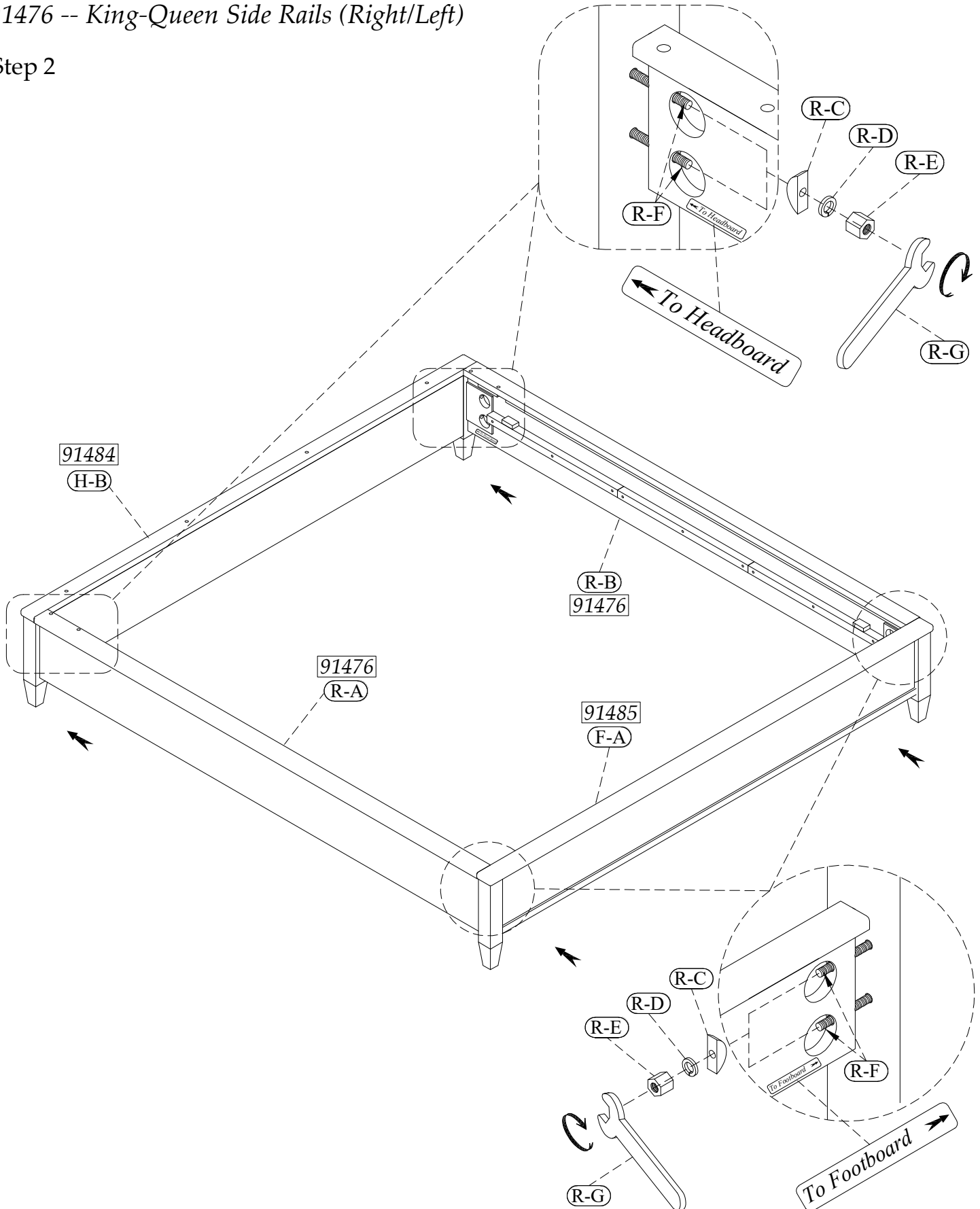

King Uph Spindle Bed

- 91484 -- King Uph Headboard (Top Assembly)
- 91484 -- King Uph Headboard (Bottom Assembly)
- 91485 -- King Spindle Footboard
- 91476 -- King-Queen Side Rails (Right/Left)

Step 3

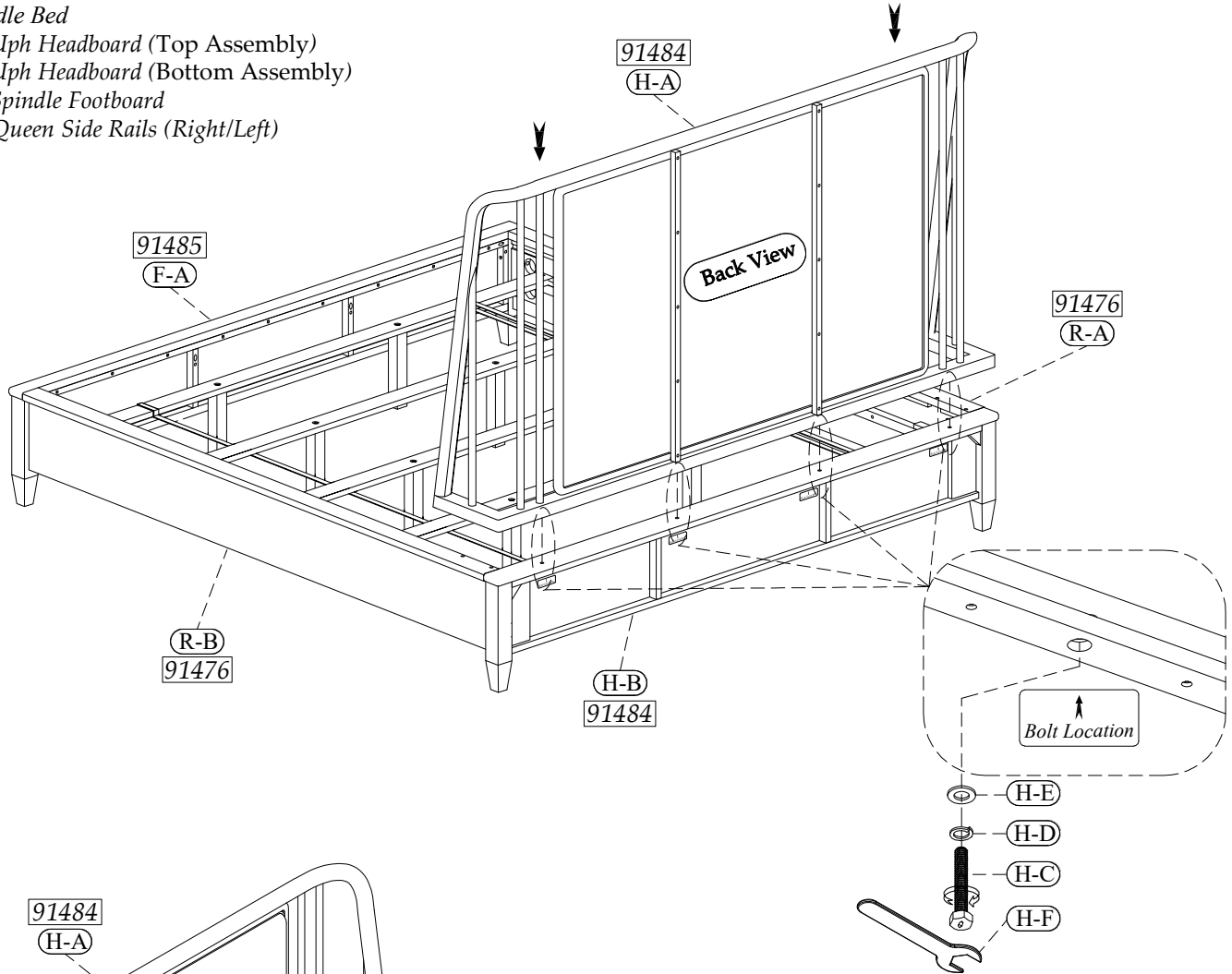

Step 4

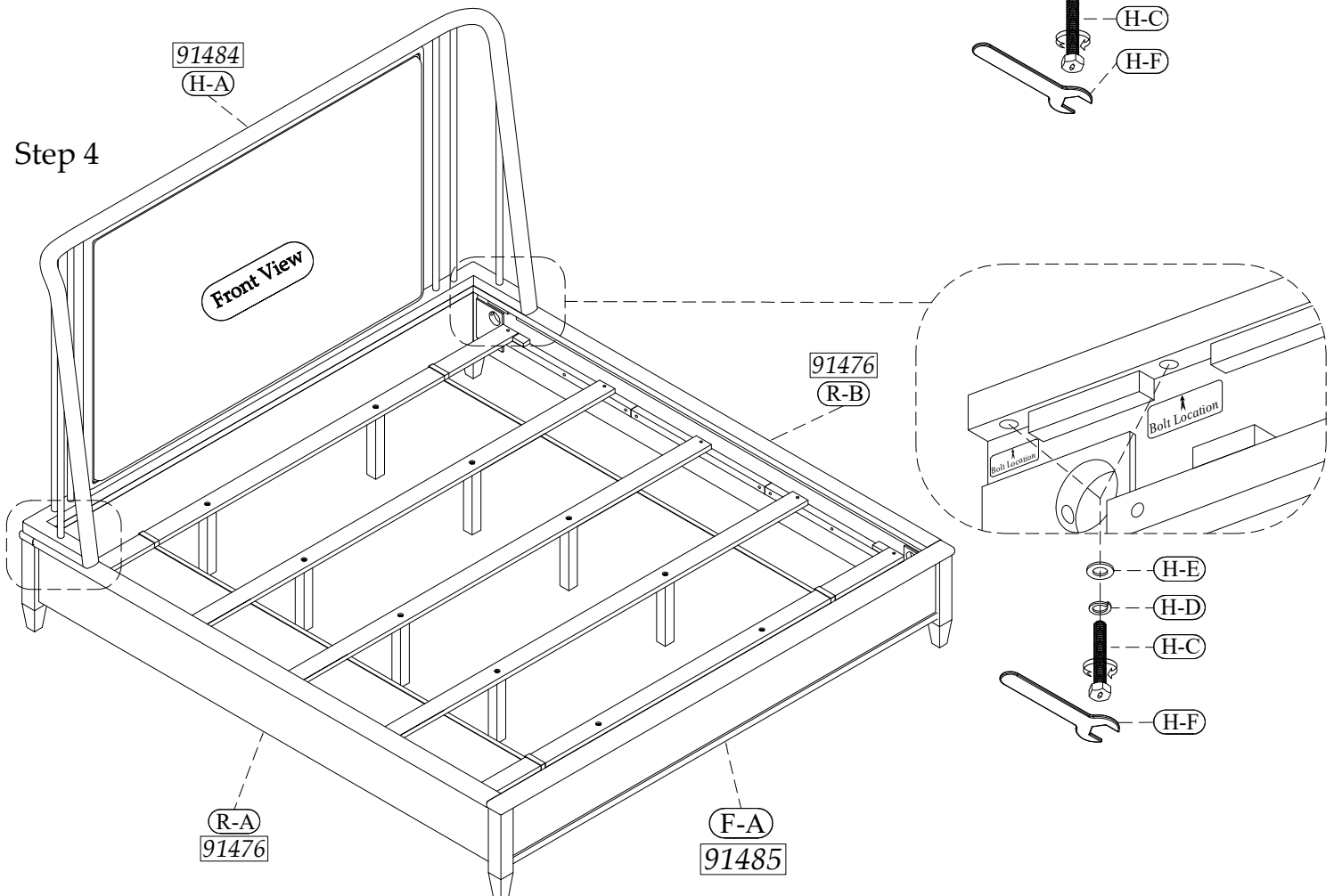

Step 5

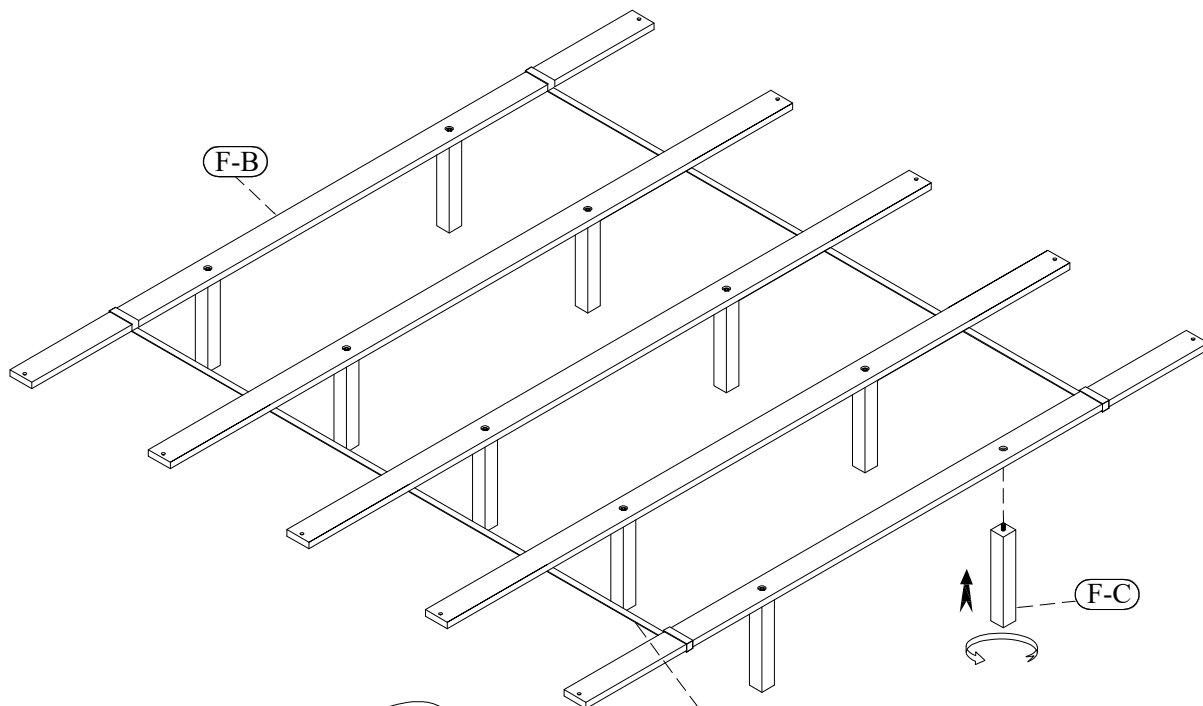

Step 6

